

# Rigid Nonmetallic Conduit – Conduit Bodies



Except where noted by ▶

## Conduit Bodies

- Hubs are not threaded
- Textured lids
- Foam-in-place gasket

### Type LB

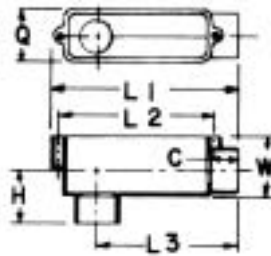
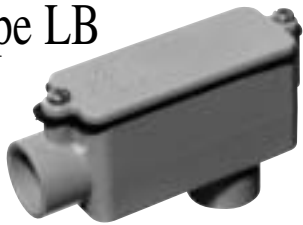

Part No.	Size	Std. Ctn. Qty.	C Typical	Max. L1	L2 Typical	L3	Max H	Max Q	Max. W	Vol. Cu. In.
E986D-CAR	1/2	10	1 <sup>11</sup> / <sub>16</sub>	4 <sup>5</sup> / <sub>16</sub>	3 <sup>7</sup> / <sub>32</sub>	3 <sup>1</sup> / <sub>16</sub>	1 <sup>5</sup> / <sub>16</sub>	1 <sup>11</sup> / <sub>32</sub>	1 <sup>1</sup> / <sub>2</sub>	4.0
E986E-CAR	3/4	10	2 <sup>9</sup> / <sub>32</sub>	6 <sup>9</sup> / <sub>32</sub>	5 <sup>9</sup> / <sub>32</sub>	4 <sup>25</sup> / <sub>32</sub>	1 <sup>25</sup> / <sub>32</sub>	1 <sup>3</sup> / <sub>4</sub>	2 <sup>1</sup> / <sub>32</sub>	12.0
E986F-CAR	1	10	2 <sup>9</sup> / <sub>32</sub>	6 <sup>9</sup> / <sub>32</sub>	5 <sup>9</sup> / <sub>32</sub>	4 <sup>25</sup> / <sub>32</sub>	1 <sup>25</sup> / <sub>32</sub>	1 <sup>3</sup> / <sub>4</sub>	2 <sup>1</sup> / <sub>32</sub>	12.0
E986G-CAR	1 <sup>1</sup> / <sub>4</sub>	5	1 <sup>3</sup> / <sub>32</sub>	7 <sup>31</sup> / <sub>32</sub>	6 <sup>13</sup> / <sub>32</sub>	6	2 <sup>5</sup> / <sub>16</sub>	2 <sup>1</sup> / <sub>2</sub>	2 <sup>3</sup> / <sub>4</sub>	32.0
E986H-CAR	1 <sup>1</sup> / <sub>2</sub>	5	1 <sup>3</sup> / <sub>32</sub>	7 <sup>31</sup> / <sub>32</sub>	6 <sup>13</sup> / <sub>32</sub>	6	2 <sup>5</sup> / <sub>16</sub>	2 <sup>1</sup> / <sub>2</sub>	2 <sup>3</sup> / <sub>4</sub>	32.0
E986J	2	10	1 <sup>5</sup> / <sub>32</sub>	9 <sup>31</sup> / <sub>32</sub>	8 <sup>13</sup> / <sub>32</sub>	7 <sup>1</sup> / <sub>4</sub>	2 <sup>9</sup> / <sub>16</sub>	3 <sup>5</sup> / <sub>32</sub>	3 <sup>15</sup> / <sub>32</sub>	63.0
▶E986K	2 <sup>1</sup> / <sub>2</sub>	4	1 <sup>5</sup> / <sub>8</sub>	14 <sup>7</sup> / <sub>8</sub>	13 <sup>1</sup> / <sub>4</sub>	11 <sup>31</sup> / <sub>32</sub>	3 <sup>3</sup> / <sub>4</sub>	4 <sup>11</sup> / <sub>32</sub>	4 <sup>5</sup> / <sub>8</sub>	210.
▶E986L	3	4	1 <sup>5</sup> / <sub>8</sub>	14 <sup>7</sup> / <sub>8</sub>	13 <sup>1</sup> / <sub>4</sub>	11 <sup>31</sup> / <sub>32</sub>	3 <sup>3</sup> / <sub>4</sub>	4 <sup>11</sup> / <sub>32</sub>	4 <sup>5</sup> / <sub>8</sub>	210.
▶E986M	3 <sup>1</sup> / <sub>2</sub>	4	1 <sup>25</sup> / <sub>32</sub>	17 <sup>23</sup> / <sub>32</sub>	15 <sup>7</sup> / <sub>8</sub>	14 <sup>17</sup> / <sub>64</sub>	4 <sup>7</sup> / <sub>16</sub>	5 <sup>11</sup> / <sub>32</sub>	5 <sup>21</sup> / <sub>32</sub>	390.
▶E986N	4	4	1 <sup>25</sup> / <sub>32</sub>	17 <sup>23</sup> / <sub>32</sub>	15 <sup>7</sup> / <sub>8</sub>	14 <sup>17</sup> / <sub>64</sub>	4 <sup>7</sup> / <sub>16</sub>	5 <sup>11</sup> / <sub>32</sub>	5 <sup>21</sup> / <sub>32</sub>	390.

### Type LR

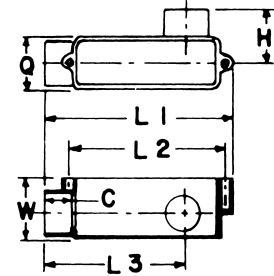

Part No.	Size	Std. Ctn. Qty.	C Typical	Max. L1	L2 Typical	L3	Max. H	Max. Q	Max. W	Vol. Cu. In.
E985D-CAR	1/2	10	1 <sup>11</sup> / <sub>16</sub>	4 <sup>5</sup> / <sub>16</sub>	3 <sup>7</sup> / <sub>32</sub>	3 <sup>1</sup> / <sub>16</sub>	1 <sup>5</sup> / <sub>16</sub>	1 <sup>11</sup> / <sub>32</sub>	1 <sup>1</sup> / <sub>2</sub>	4.0
E985E-CAR	3/4	10	2 <sup>9</sup> / <sub>32</sub>	6 <sup>9</sup> / <sub>32</sub>	5 <sup>9</sup> / <sub>32</sub>	4 <sup>25</sup> / <sub>32</sub>	1 <sup>25</sup> / <sub>32</sub>	1 <sup>3</sup> / <sub>4</sub>	2 <sup>1</sup> / <sub>32</sub>	12.0
E985F-CAR	1	10	2 <sup>9</sup> / <sub>32</sub>	6 <sup>9</sup> / <sub>32</sub>	5 <sup>9</sup> / <sub>32</sub>	4 <sup>25</sup> / <sub>32</sub>	1 <sup>25</sup> / <sub>32</sub>	1 <sup>3</sup> / <sub>4</sub>	2 <sup>1</sup> / <sub>32</sub>	12.0
E985G-CAR	1 <sup>1</sup> / <sub>4</sub>	5	1 <sup>3</sup> / <sub>32</sub>	7 <sup>31</sup> / <sub>32</sub>	6 <sup>13</sup> / <sub>32</sub>	6	2 <sup>5</sup> / <sub>16</sub>	2 <sup>1</sup> / <sub>2</sub>	2 <sup>3</sup> / <sub>4</sub>	32.0
E985H-CAR	1 <sup>1</sup> / <sub>2</sub>	5	1 <sup>3</sup> / <sub>32</sub>	7 <sup>31</sup> / <sub>32</sub>	6 <sup>13</sup> / <sub>32</sub>	6	2 <sup>5</sup> / <sub>16</sub>	2 <sup>1</sup> / <sub>2</sub>	2 <sup>3</sup> / <sub>4</sub>	32.0
E985J	2	10	1 <sup>5</sup> / <sub>32</sub>	9 <sup>31</sup> / <sub>32</sub>	8 <sup>13</sup> / <sub>32</sub>	7 <sup>1</sup> / <sub>4</sub>	2 <sup>9</sup> / <sub>16</sub>	3 <sup>5</sup> / <sub>32</sub>	3 <sup>15</sup> / <sub>32</sub>	63.0

### Type E

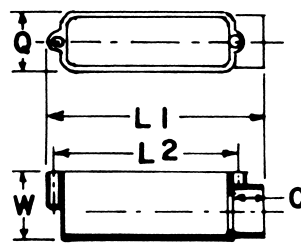
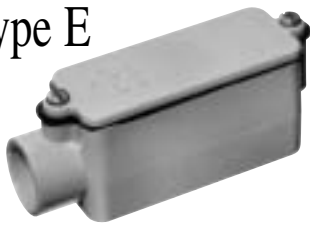

Part No.	Size	Std. Ctn. Qty.	C	L1	L2	Q	W	Vol. Cu. In.
E988D-CAR	1/2	5	1 <sup>11</sup> / <sub>16</sub>	4 <sup>5</sup> / <sub>16</sub>	3 <sup>1</sup> / <sub>2</sub>	1 <sup>11</sup> / <sub>32</sub>	1 <sup>1</sup> / <sub>2</sub>	4.0
E988E	3/4	20	2 <sup>9</sup> / <sub>32</sub>	6 <sup>11</sup> / <sub>32</sub>	5 <sup>9</sup> / <sub>32</sub>	1 <sup>3</sup> / <sub>4</sub>	2 <sup>1</sup> / <sub>32</sub>	12.0
E988F-CAR	1	10	2 <sup>9</sup> / <sub>32</sub>	6 <sup>11</sup> / <sub>32</sub>	5 <sup>9</sup> / <sub>32</sub>	1 <sup>3</sup> / <sub>4</sub>	2 <sup>1</sup> / <sub>32</sub>	12.0
E988G-CAR	1 <sup>1</sup> / <sub>4</sub>	5	1 <sup>3</sup> / <sub>32</sub>	8	6 <sup>13</sup> / <sub>32</sub>	2 <sup>1</sup> / <sub>2</sub>	2 <sup>3</sup> / <sub>4</sub>	32.0
E988H-CAR	1 <sup>1</sup> / <sub>2</sub>	5	1 <sup>3</sup> / <sub>32</sub>	8	6 <sup>13</sup> / <sub>32</sub>	2 <sup>1</sup> / <sub>2</sub>	2 <sup>3</sup> / <sub>4</sub>	32.0
E988J	2	5	1 <sup>5</sup> / <sub>32</sub>	9 <sup>15</sup> / <sub>32</sub>	8 <sup>13</sup> / <sub>32</sub>	3 <sup>5</sup> / <sub>32</sub>	3 <sup>15</sup> / <sub>32</sub>	63.0

### Type T

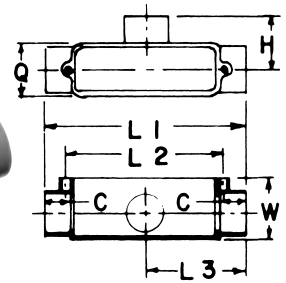

Part No.	Size	Std. Ctn. Qty.	C Typical	Max. L1	L2 Typical	L3	Max. H	Max. Q	Max. W	Vol. Cu. In.
E983D-CAR	1/2	10	1 <sup>11</sup> / <sub>16</sub>	4 <sup>11</sup> / <sub>16</sub>	3 <sup>7</sup> / <sub>32</sub>	2 <sup>11</sup> / <sub>32</sub>	1 <sup>5</sup> / <sub>16</sub>	1 <sup>11</sup> / <sub>32</sub>	1 <sup>1</sup> / <sub>2</sub>	4.0
E983E-CAR	3/4	10	2 <sup>9</sup> / <sub>32</sub>	6 <sup>7</sup> / <sub>8</sub>	5 <sup>9</sup> / <sub>32</sub>	4 <sup>7</sup> / <sub>16</sub>	1 <sup>25</sup> / <sub>32</sub>	1 <sup>3</sup> / <sub>4</sub>	2 <sup>1</sup> / <sub>32</sub>	12.0
E983F	1	20	2 <sup>9</sup> / <sub>32</sub>	6 <sup>7</sup> / <sub>8</sub>	5 <sup>9</sup> / <sub>32</sub>	3 <sup>7</sup> / <sub>16</sub>	1 <sup>25</sup> / <sub>32</sub>	1 <sup>3</sup> / <sub>4</sub>	2 <sup>1</sup> / <sub>32</sub>	12.0
E983G	1 <sup>1</sup> / <sub>4</sub>	10	1 <sup>3</sup> / <sub>32</sub>	8 <sup>21</sup> / <sub>32</sub>	6 <sup>13</sup> / <sub>32</sub>	4 <sup>21</sup> / <sub>64</sub>	2 <sup>5</sup> / <sub>16</sub>	2 <sup>1</sup> / <sub>2</sub>	2 <sup>3</sup> / <sub>4</sub>	32.0
E983H-CAR	1 <sup>1</sup> / <sub>2</sub>	4	1 <sup>3</sup> / <sub>32</sub>	8 <sup>21</sup> / <sub>32</sub>	6 <sup>13</sup> / <sub>32</sub>	4 <sup>21</sup> / <sub>64</sub>	2 <sup>5</sup> / <sub>16</sub>	2 <sup>1</sup> / <sub>2</sub>	2 <sup>3</sup> / <sub>4</sub>	32.0
E983J	2	10	1 <sup>5</sup> / <sub>32</sub>	10 <sup>5</sup> / <sub>16</sub>	8 <sup>13</sup> / <sub>32</sub>	5 <sup>9</sup> / <sub>32</sub>	2 <sup>9</sup> / <sub>16</sub>	3 <sup>5</sup> / <sub>32</sub>	3 <sup>15</sup> / <sub>16</sub>	63.0

### Type C

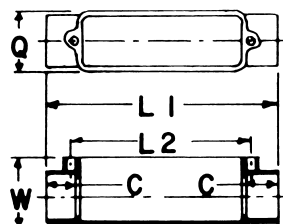
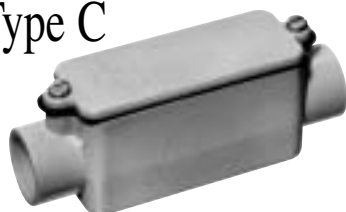

Part No.	Size	Std. Ctn. Qty.	C Typical	Max. L1	L2 Typical	Max. Q	Max. W	Vol. Cu. In.
E987D-CAR	1/2	10	1 <sup>11</sup> / <sub>16</sub>	4 <sup>11</sup> / <sub>16</sub>	3 <sup>1</sup> / <sub>2</sub>	1 <sup>11</sup> / <sub>32</sub>	1 <sup>1</sup> / <sub>2</sub>	4.0
E987E-CAR	3/4	10	2 <sup>9</sup> / <sub>32</sub>	6 <sup>7</sup> / <sub>8</sub>	5 <sup>32</sup> / <sub>64</sub>	1 <sup>3</sup> / <sub>4</sub>	2 <sup>1</sup> / <sub>32</sub>	12.0
E987F-CAR	1	10	2 <sup>9</sup> / <sub>32</sub>	6 <sup>7</sup> / <sub>8</sub>	5 <sup>9</sup> / <sub>32</sub>	1 <sup>3</sup> / <sub>4</sub>	2 <sup>1</sup> / <sub>32</sub>	12.0
E987G-CAR	1 <sup>1</sup> / <sub>4</sub>	5	1 <sup>3</sup> / <sub>32</sub>	8 <sup>21</sup> / <sub>32</sub>	6 <sup>13</sup> / <sub>32</sub>	2 <sup>1</sup> / <sub>2</sub>	2 <sup>3</sup> / <sub>4</sub>	32.0
E987H-CAR	1 <sup>1</sup> / <sub>2</sub>	4	1 <sup>3</sup> / <sub>32</sub>	8 <sup>21</sup> / <sub>32</sub>	6 <sup>13</sup> / <sub>32</sub>	2 <sup>1</sup> / <sub>2</sub>	2 <sup>3</sup> / <sub>4</sub>	32.0
E987J	2	15	1 <sup>5</sup> / <sub>32</sub>	10 <sup>5</sup> / <sub>16</sub>	8 <sup>13</sup> / <sub>32</sub>	3 <sup>5</sup> / <sub>32</sub>	3 <sup>15</sup> / <sub>32</sub>	63.0

### Type LL

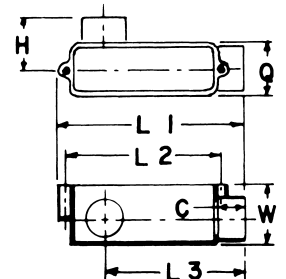
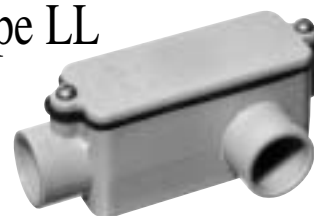

Part No.	Size	Std. Ctn. Qty.	C Typical	Max. L1	L2 Typical	L3	Max. H	Max. Q	Max. W	Vol. Cu. In.
E984D-CAR	1/2	10	1 <sup>11</sup> / <sub>16</sub>	4 <sup>5</sup> / <sub>16</sub>	3 <sup>7</sup> / <sub>32</sub>	3 <sup>1</sup> / <sub>16</sub>	1 <sup>5</sup> / <sub>16</sub>	1 <sup>11</sup> / <sub>32</sub>	1 <sup>1</sup> / <sub>2</sub>	4.0
E984E-CAR	3/4	8	2 <sup>29</sup> / <sub>32</sub>	6 <sup>9</sup> / <sub>32</sub>	5 <sup>9</sup> / <sub>32</sub>	4 <sup>25</sup> / <sub>32</sub>	1 <sup>25</sup> / <sub>32</sub>	1 <sup>3</sup> / <sub>4</sub>	2 <sup>1</sup> / <sub>32</sub>	12.0
E984F-CAR	1	10	2 <sup>29</sup> / <sub>32</sub>	6 <sup>9</sup> / <sub>32</sub>	5 <sup>9</sup> / <sub>32</sub>	4 <sup>25</sup> / <sub>32</sub>	1 <sup>25</sup> / <sub>32</sub>	1 <sup>3</sup> / <sub>4</sub>	2 <sup>1</sup> / <sub>32</sub>	12.0
E984G-CAR	1 <sup>1</sup> / <sub>4</sub>	5	1 <sup>3</sup> / <sub>32</sub>	7 <sup>31</sup> / <sub>32</sub>	6 <sup>13</sup> / <sub>32</sub>	6	2 <sup>5</sup> / <sub>16</sub>	2 <sup>1</sup> / <sub>2</sub>	2 <sup>3</sup> / <sub>4</sub>	32.0
E984H-CAR	1 <sup>1</sup> / <sub>2</sub>	5	1 <sup>3</sup> / <sub>32</sub>	7 <sup>31</sup> / <sub>32</sub>	6 <sup>13</sup> / <sub>32</sub>	6	2 <sup>5</sup> / <sub>16</sub>	2 <sup>1</sup> / <sub>2</sub>	2 <sup>3</sup> / <sub>4</sub>	32.0
E984J	2	10	1 <sup>5</sup> / <sub>32</sub>	9 <sup>9</sup> / <sub>32</sub>	8 <sup>13</sup> / <sub>32</sub>	7 <sup>1</sup> / <sub>4</sub>	2 <sup>9</sup> / <sub>16</sub>	3 <sup>5</sup> / <sub>32</sub>	3 <sup>15</sup> / <sub>32</sub>	63.0
E984J-CAR	2	3	1 <sup>5</sup> / <sub>32</sub>	9 <sup>9</sup> / <sub>32</sub>	8 <sup>13</sup> / <sub>32</sub>	7 <sup>1</sup> / <sub>4</sub>	2 <sup>9</sup> / <sub>16</sub>	3 <sup>5</sup> / <sub>32</sub>	3 <sup>15</sup> / <sub>32</sub>	63.0



Except where noted by ▶

## Washers

### Flat Sealing Washer

Where a waterproof termination is required into any enclosure (metallic or nonmetallic), install the neoprene washer over the threads of a terminal adapter before inserting into the enclosure. Use a standard locknut or threaded bushing to secure the assembly.



Part No.	Size	Std. Ctn. Qty.
▶ E943DW	1/2	125
▶ E943EW	3/4	125
▶ E943FW	1	100
▶ E943GW	1 1/4	50
▶ E943HW	1 1/2	50
▶ E943JW	2	25

## Sleeves

### HOLFORM™ Concrete Sleeves

HOLFORM nonmetallic concrete sleeve forms are the easy way to form holes in concrete. They install in seconds with nails, screws or staples and are easily removed. Concrete will not adhere to them. HOLFORMS are adjustable to any slab thickness.



Part No.	Min. O.D. A	B	Std. Ctn. Qty.	Std. Ctn. Wt. (lbs.)
▶ E92CSH	1 1/2	1 3/4	20	3
▶ E92CSJ	2	2 13/32	25	6
▶ E92CSL	3	3 13/32	25	8
▶ E92CSN	4	4 13/32	18	8
▶ E92CSP	5	5 13/32	15	8
▶ E92CSR	6	6 13/32	12	8

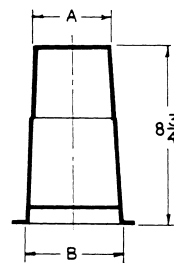

## Lock Nuts



### PVC Lock Nut



Part No.	Size	Std. Ctn. Qty.
▶ LT9LD	1/2	1200
▶ LT9LE	3/4	700
▶ LT9LF	1	600

## Conduit Bodies

### Type X with Cover

Four knock-out type socket openings, 90° spacing. Available with 1/2" or 3/4" socket outlets. Includes cover and gasket.



## Pull Elbows

### Access Pull Elbows



Gasket included.

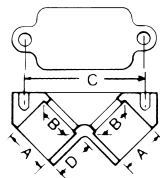

Part No.	Size	Std. Ctn. Qty.	A Typical	B Typical	C Typical	D Typical
E990D	1/2	75	.852	.836	2.187	.718
E990DR-CAR	1/2	25	.852	.836	2.187	.718
E990E	3/4	50	1.064	1.046	2.531	.781
E990ER-CAR	3/4	20	1.064	1.046	2.531	.781

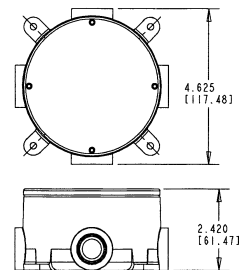
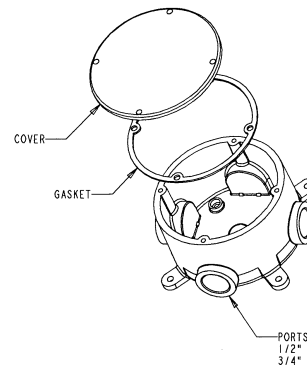

Part No.	Size	Vol. Cu. In.	Std. Ctn. Qty.
E970CD	1/2	15.16	15
E970CE	3/4	15.16	15

Supplied with 4 stainless steel cover screws. Diameter 4 1/8", Thickness 1/4".  
\*Not designed for use with wiring devices or light fixtures.